



Cardiff & The Vale

Natural Burial Meadow

Leedam





Look out over familiar places

The western meadows are sheltered in woodland. To the east, meanwhile, vistas open towards the Garth Mountain, along the Taff Valley to Castell Coch, St Fagans, Caerphilly Mountain and Craig Llysfaen.

The further east you walk, the more of the city you'll see. Head across to the tall beech trees in the south-eastern high ground and, on a sunny day, you'll catch the light dancing on the surface of the Severn Estuary, the two bridges leading your eyes across to the Mendip Hills of Somerset in the distance.

The beauty of the meadow evolves with the passing seasons. At any time of year, a visit to the burial ground will connect you with nature.

You'll have space to focus. To reflect on life, love, and loss.

How it works

A natural burial is the most ecological funeral option, a thoughtful legacy for future generations. The meadow will remain as it is now, permanent pasture - genuine, farmed countryside.

In advance

- Visit the burial meadow and spend time there getting to know it and deciding whether it's right for you.
- Download an application form from our website, or phone us and we'll send you an information pack.
- Pre-purchase at today's rate. Options available to pay by standing order.

Practicalities

We recommend stout footwear as the ground is uneven. A foldable chair is a good idea for those who find it difficult to stand and remember, there's no such thing as bad weather, just the wrong sort of clothes...

There is a wealth of information about natural burial on our website www.cardiffnaturalburials.co.uk and we are here in the Leedam office to answer your questions - 01600 716438.

When planning a funeral

- Complete an interment form to let us know your plans for the day so that we can help you achieve your wishes.
- Make the arrangements yourself or ask your funeral director to do this for you.
- Book the date and time with us. Burials may take place 10am-1.30pm on weekdays by arrangement.



Our custodian



Annabelle Traherne

Tel: 01446 760321

Office: 01600 716438

Email: cardiff@leedam.com



Our custodian at Cardiff natural burial meadow is Annabelle Traherne. Annabelle and her husband Rhodri own the Traherne estate and take great pride in ensuring that the meadow is maintained to the highest standard at all times.

On the day of a funeral, Annabelle will be there to welcome and look after you.

Please contact the office if you would like to arrange a visit or learn more about having a natural burial at Cardiff. If you prefer to explore the burial meadow independently, please feel free to visit and have a wander around.



More time and space

The natural burial ground in Cardiff is an open meadow, punctuated by mature trees framing scenic views across the Vale.

It is tranquil and private. An unhurried and gentle place to get away from it all. It is somewhere quiet to be with your memories, to take one step at a time, close to nature, whatever the weather, throughout the seasons.

A large, leafy tree with a thick trunk and dense canopy of green and brown leaves stands in a lush green field. The background shows a clear blue sky and distant hills. The text is overlaid on the lower right portion of the image.

“A sad occasion became
full of love, friendship
and time for reflection”



Make the day your own

The meadow gives you the freedom to be yourselves. Whether you are planning a simple interment with only a few in attendance or a larger funeral event we will offer inspiration, support and guidance, so you can organise the day exactly as you'd like it.

If it rains, the memorial shelter provides space for gatherings and refuge from the weather.



Flowers

Consider using flowers from your garden, or a friend's, or produce from the veg patch to create a hand-tied bouquet. Ask florists to use these or locally grown flowers. No plastic, Oasis foam or wire, please.

Think about scattering petals from a basket or single stems into the grave.



Personal touches

Choose the best format, music, ceremony and style to suit the person who has died.

You could celebrate with an open-air picnic; wear bright colours or a favourite team's strip; arrive by motorbike or horse and carriage. You have the time and space to do it your way.



Memorial plaques

Oak memorial plaques engraved with names and dates commemorate people buried in the meadow.

The plaques are housed between the upright timbers of the walls of the memorial shelter, located within the top corner of the meadow nearest the entrance.

Rights to display a plaque are granted for a period of 25 years after which they can be renewed.

Alwyn Littlewood

1943 - 2010

Peter J. Twedde

1938 - 2008

Susan Patricia Ravenhill

1949 - 2010

Doreen Waring

1924 - 2010

John Desmond Newton

1935 - 2007

Stan R. L. Westacott

1927 - 2010

Barry Rees

1973 - 2010

Robert L. H. K. Pattinson

1930 - 2009

Felicity Nash

1927 - 2009

Simon Christopher Cresser

1988 - 2010

Elsie Rabjohns

1907 - 2010

Finding the spot

Graves are carefully mapped and their exact GPS locations and What3Words addresses are recorded and shared with you so that you'll know where to visit.

If you struggle with any of these, don't worry - call us, we'll help.

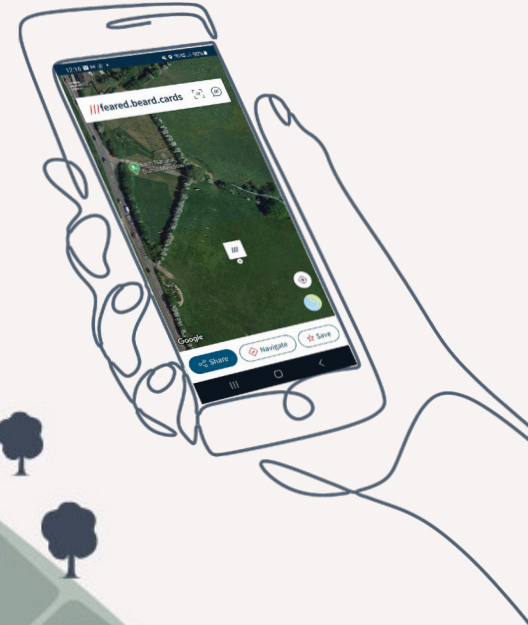
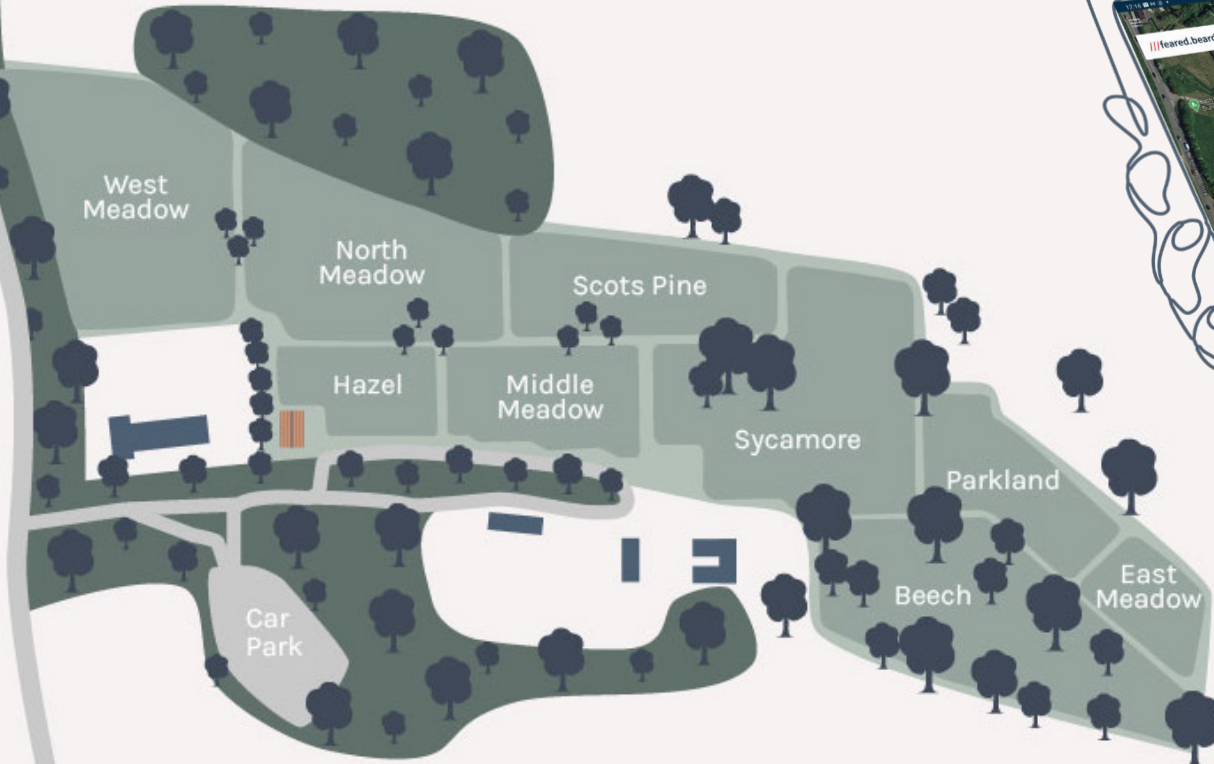



Cardiff Natural Burial Meadow

Coedarhydyglyn Park, St Nicholas, Cardiff CF5 6SG
(not for correspondence)

[Google Maps Plus Code: FP83+8H Cardiff](#)

What3Words.com///doctor.grants.wink

You can find us on the A48 towards Cowbridge. Go past M&S (on your right) and continue up the hill to the top. After approximately half a mile take the first right, look for the 'Natural Burial Ground' signs. The entrance is 200 metres on the right.

Custodian

Annabelle Traherne
t. 01446 760321
e. cardiff@leedam.com

Office

Leedam Natural Heritage
26 Agincourt Square
Monmouth, NP25 3BT
t. 01600 716438

Facebook [@cardiffnaturalburials](#)
Instagram [@cardiff_natural_burials](#)
www.cardiffnaturalburials.co.uk



**Leedam**

Leedam Natural Heritage is a trading name of
Native Woodland Ltd, registered in Scotland
Company No. SC240278

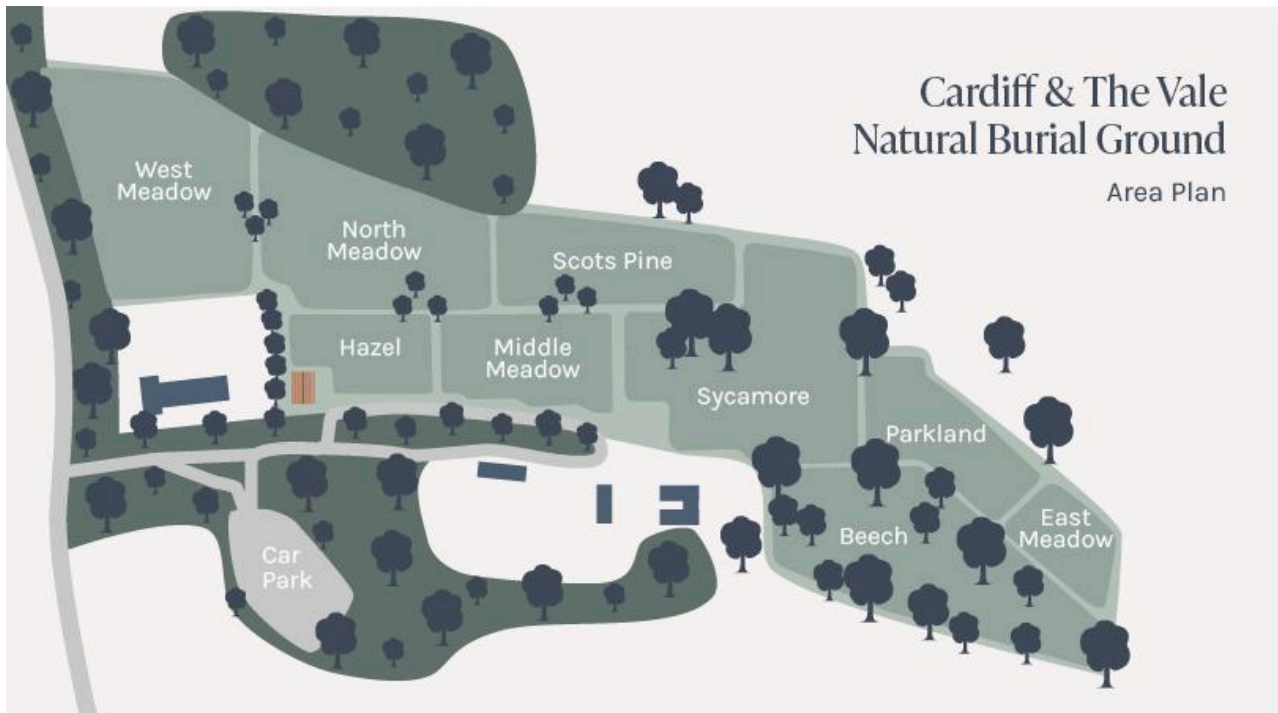

Burial Rights	Price
Burial Plot - Hazel	£1,000
Burial Plot - Middle Meadow	£1,390
Burial Plot - North Meadow	£910
Burial Plot - West Meadow	£1,515
Burial Plot - Scots Pine	£1,740
Burial Plot - Sycamore	£1,930
Burial Plot - Parkland	£4,500
Registration Fee	£255

Optional Items	Price
Extra Ashes in Same Plot	£255
Oak Plaque (25 years)	£360
Blank Oak Plaque	£80
Standing Order Admin Fee*	£85

Ashes Rights	Price
Ashes Plot - Hazel	£500
Ashes Plot - Middle Meadow	£680
Ashes Plot - North Meadow	£455
Ashes Plot - West Meadow	£755
Ashes Plot - Scots Pine	£870
Ashes Plot - Sycamore	£955
Ashes Plot - Beech	£1,185
Ashes Plot - East Meadow	£1,185
Ashes Plot - Parkland	£2,250
Registration Fee	£255

Grave digging	Price
Grave Digging for Burial	£610
Grave Digging for Ashes	£215

Interment form - Valid from 1 April 2026 - 31 March 2027

1. Who is filling this form in?

Your name	
Your address	
Your email address	
Your telephone number(s)	

2. Who has died?

Their full name			
The deceased's address			
Their date of birth		The date of death	
Your relationship to the deceased?	<i>You are the deceased's...</i>		
Who is the deceased's primary representative?			
Their telephone number			
Their email address			

3. Funeral director - if you are using one

Company name	
Contact name	
Contact email address	
Contact telephone number(s)	

4. The grave

Type of grave	<input type="checkbox"/> Burial	<input type="checkbox"/> Ashes
Are the rights pre-purchased?	<input type="checkbox"/> No	<input type="checkbox"/> Yes
If yes, the Register Number	<input type="checkbox"/> 05 -	

Next to an existing grave?	<input type="checkbox"/> No		<input type="checkbox"/> Yes	
If yes, next to whom?	<input type="checkbox"/>			
Would you like to reserve the adjacent plot?	<input type="checkbox"/> No	<input type="checkbox"/> Provisional (for 1 year)	<input type="checkbox"/> Yes - burial plot	<input type="checkbox"/> Yes - ashes plot
If yes, please provide their:	Name			
	Address			
	Date of birth			
	Phone no.			

5. The coffin, casket or shroud

What material is it made of?					
What shape is it?					
<i>Please note - NO PLASTIC LININGS or polyester trimmings must be used. Line with canvas or paper.</i>					
Accurate exterior dimensions	Length		Width		Height

6. Extra ashes within the coffin/casket/grave

Extra ashes?	<input type="checkbox"/> No		<input type="checkbox"/> Human ashes <i>Human ashes require an additional registration fee.</i>	
For extra human ashes, please provide their:	Name			
	Their last address			
	Date of birth			
	Date of death			

7. The event

Requested date <i>(burial on weekdays only)</i>			
Requested arrival time: <i>11am-1:30pm</i>		Estimated departure:	
What type of event are you planning?	<input type="checkbox"/> Simple committal with a graveside service <input type="checkbox"/> Committal after a service elsewhere <input type="checkbox"/> A longer celebration of life <input type="checkbox"/> Other...		
Who will carry the coffin?	<input type="checkbox"/> Funeral director's staff <input type="checkbox"/> Family and friends <input type="checkbox"/> A combination (FD + Family and friends)		
Number of people expected		Number of cars:	
Name of officiant (if any)			

8. Optional items

An oak memorial plaque mounted in the memorial shelter for 25 years (renewable)			
Name to go on plaque <i>(Max 28 letters and spaces)</i>			
Year of birth		Year of death	

9. Fee summary - Leedam

Item	Cost	Quantity	Total
Registration fee	£255	1	£255
Burial - Hazel	£1000		
Burial - Middle Meadow	£1390		
Burial - North Meadow	£910		
Burial - West Meadow	£1515		
Burial - Scots Pine	£1740		

Burial - Sycamore	£1930		
Burial - Parkland	£4500		
Ashes - Hazel	£500		
Ashes - Middle Meadow	£680		
Ashes - North Meadow	£455		
Ashes - West Meadow	£755		
Ashes - Scots Pine	£870		
Ashes - Sycamore	£955		
Ashes - Beech	£1185		
Ashes - East Meadow	£1185		
Ashes - Parkland	£2250		
Extra human ashes in plot	£255		
Memorial plaque	£360		
Weekend custodian fee	£85		
Total price:			
<p><i>Payable to: Leedam Natural Burials, Account No: 47269136, Sort Code: 04-00-06</i> <i>Call us (01600716438) if you are unable to pay by bank transfer, and we will share a card payment link.</i></p>			

10. Fee summary - Grave digging

Item	Cost	Total
Grave digging - Burial	£610	
Grave digging - Ashes	£215	
<p><i>Burial grave digging is payable to: Traherne Farms Ltd., Account No: 97936332, Sort Code: 56-00-41</i></p>		

Who will be responsible for payment?

- Applicant
 Funeral Director
 Other (please provide name & address)

11. Applicant's signature and declaration

The information given on this form is accurate. I am the person to whom all correspondence should be sent and am responsible for paying the amounts shown in the table below and agree to be bound by Leedam's Terms and Conditions (www.leedam.co.uk/burial-contract) and the Burial Ground Regulations (www.leedam.com/rules-and-regulations/) which apply.

Signature		Date	
Full name			

Updates and how we use your personal data

Marketing preferences (you can withdraw consent at any time): Email Post Phone

Your personal data will be used to confirm your purchase, register your rights, and share relevant details with our site custodian. We may also use it for anonymised statistical analysis. We will not share your data with third parties. View our privacy policy at leedam.com/privacy-policy.

Please note that burial law requires us to maintain a public register recording the date of burial, full name, age, address and grave number of the deceased.

Terms & Conditions

Your Rights of Burial

Your Selected Rights of Burial give you the right to have remains interred in your chosen area of the burial ground. They do not confer land ownership, cannot be sold or transferred without our written consent, and remain personal to you. Rights must be exercised within 50 years of purchase.

Payment and Certificate

Your Certificate will be issued once payment is received in full. Full payment is required at least two working days before the funeral date. The Certificate (and any duplicates) must be surrendered to us before burial can take place.

Cancellation and Refunds

Refunds are available for five years from the date of full payment, as follows: Within 14 days: full refund | 15 days to 3 months: 90% refund | 3 months to 1 year: 75% refund | 1 year to 5 years: 50% refund. No refund is available after five years, or after the death of the Nominee. To cancel, notify us in writing and return the Certificate.

Transfers

Rights may be transferred to a new Nominee before burial, subject to our written consent and a fee of £200 per right. The original purchase date is retained for any future refund calculation.

Conditions of Burial

Only biodegradable coffins, urns or shrouds from sustainable sources may be used. Embalmed remains cannot be interred. We must receive at least three clear working days' notice before interment, along with the completed Interment Form, Certificate, and all relevant fees. No memorials, markers or plantings are permitted unless specifically agreed by us.

Site Management

The burial ground is managed primarily for wildlife and agriculture. We retain sole discretion over planting, landscaping and maintenance. Only the Nominated Grave Digger may excavate graves. Grave excavation costs are not included in the purchase price.

Availability

In the event that ground conditions or other circumstances make your selected area unavailable, we will offer reasonable alternatives. If alternatives are not accepted, a full refund will be issued within 28 days.

Your Responsibilities

You and your Representatives are responsible for complying with all relevant legislation and our reasonable site instructions, and for the conduct of all persons attending the burial ground with your consent.

Full terms and conditions can be viewed at: www.leedam.com/burial-contract

Return by email to cardiff@leedam.co.uk or by post to: Leedam Natural Burials, Apex House, Office 16, Wonastow Industrial Estate East, Monmouth NP25 5JB | 01600 716 438

Cardiff & The Vale

Natural Burial Meadow

Contact details

Company name	Leedam Natural Heritage
Head office	Leedam Natural Heritage, Apex House, Office 16, Wonastow Industrial Estate East, Monmouth, NP25 5JB
Office telephone	01600 716438
Cardiff telephone	01446 364128
Email	cardiff@leedam.co.uk
Website	www.cardiffnaturalburials.co.uk
Facebook	facebook.com/cardiffnaturalburials

Funeral arrangements

Burial ground name	Cardiff & The Vale Natural Burial Ground
Location	Coedarhydyglyn Park St Nicholas Cardiff CF5 6SG
Access	Open year-round. The pedestrian gate into the meadow is not locked. The car park is locked after 5 pm overnight. Please let wheelchair users know that there are no paths across the grass.
Description	Elevated, picturesque parkland with far-reaching views across the city and Vale principally towards St Fagans, Castell Coch and the Garth Mountain. The burial ground is divided into named areas, each of which offers something different.
Ethos	Keep things simple, natural and sustainable. Beautiful countryside preserved for future generations.
On-site facilities	Car parking and large memorial shelter. No rooms, chapels, toilets or mortuary facilities.
Operator and owner	Operator: Leedam Natural Heritage. Owner - Traherne Farms Ltd.
Custodian	Annabelle Traherne, tel: 07850091199

Cardiff & The Vale

Natural Burial Meadow

Tel: 01446 364128

Procedures

Prices and forms	A price list and all forms are available on the website: www.leedam.com/locations/cardiff/forms-and-prices
Provisional booking	Call 01600 716438 to make a provisional funeral booking, after the death has been certified, and let us know the requested date, name of the deceased, your own contact details and any prior purchase information.
Confirmation	We will check the calendar to make sure the date is available, then contact the gravedigger and custodian to make sure they are also available before confirming the booking.
Submit forms	Complete an online application form, or download a PDF from the website and at least three days before the event email it to cardiff@leedam.co.uk with a scanned copy of the Coroner's Order of Burial or a Registrar's Certificate (or cremation certificate for an ashes interment).
Payments	We will send you invoices and payment is made by bank transfer. We required payment no less than two days before the event. The gravedigger is paid separately, and will also require payment before the event. We will send you a receipt and confirm that everything is OK.
Embalming	Embalming is not permitted. Embalming fills the body with toxic chemicals, which we do not wish to introduce into the soil. We would only accept embalmed remains in exceptional circumstances, e.g. repatriation.
Choosing a plot	The burial ground is divided into nine areas with different prices. Arrange a family visit to the burial ground with the Custodian (07850091199) to choose an area and be shown the next available plot.
Double plots	Plots are single depth. Double plots are arranged side by side. The second plot can be paid for in full or costs can be spread over 10 or 20 months by setting up a monthly standing order (extra admin charge applies). If undecided, we can provisionally reserve it for 1 year, after which it may be offered to others.
Coffins etc	Choose an eco-coffin, casket or shroud. All materials, including linings and clothing, should be natural and biodegradable. No veneered MDF or chipboard, please. Standard nameplates are OK or a handwritten card label with the deceased's name and dates. <i>TIP - Use calico canvas instead of polythene Crem Film.</i>

Cardiff & The Vale

Natural Burial Meadow

Tel: 01446 364128

Coffin size	Please measure and include the true maximum external dimensions of the coffin on the Interment Forms. If in doubt please call us.
Grave digging	Our nominated gravedigger will prepare the grave ready for your arrival. Graves are single depth 1.3m; double plots are arranged side by side. Payment is made directly to the grave digger. We will send you a pro forma invoice with instructions before the funeral.
On the day	<p>There is usually only one burial on the day and time is not limited. The Custodian will be there to meet and direct you.</p> <p>The vehicular gate into the meadow will be open for the hearse, limousine and family mourners with limited mobility who display the priority parking sign in the windscreen. More info: www.leedam.com/advice/disabled-access</p> <p><i>TIP - Estate cars are popular with families instead of the formal herease.</i></p>
Dogs and pets	Dogs offer comfort and companionship, especially at funerals. Dogs on leads are welcome at the burial meadow.
Music	There is no electrical power supply in the burial ground. Make sure that battery-powered speakers are powerful enough to deliver good sound quality. Live, acoustic music is always beautiful.
What to wear	Wellies/hiking shoes (not high-heels); warm, windproof clothes. <i>TIP - Bring folding chairs, scarves, hats and blankets for the elderly.</i>
Carrying the coffin	The ground is uneven, so it is recommended to carry the coffin underarm rather than on shoulders, feet first. Set up trestles at regular resting points if the carry distance is long.
Webbing	Our gravedigger supplies sanitised webbing, so there is no need to bring your own.
Flowers	Seasonal flowers from the garden or produce from the veg patch are perfect. Please let florists know it is for a natural burial, so no plastic, Oasis foam or wire. Arrangements should be taken away at the end of the event. Please let the custodian know if a posy of flowers is to be left on the grave. <i>TIP - Bring a basket of petals from the garden to scatter into the grave.</i>
Items in the grave	Additional ashes can be included in the grave, please include details on the application form. You can also include natural tributes e.g. wooden boat, sea shells; a sealed museum jar with significant pieces, or other inert objects.

Cardiff & The Vale

Natural Burial Meadow

Tel: 01446 364128

After the funeral	We will issue a certificate of interment, by email, with the precise grave location details. This will be in pdf format for sharing.
Finding the grave	The certificate of interment will include links to Google Maps, GPS coordinates and the What3Words address of the grave. The What3Words mobile app is an easy way to navigate to the grave. If there is any concern, we can flag the spot.
Memorials	To keep the land sustainable for the future as pasture, individual graves are not marked. Instead, oak plaques inscribed with the names and dates are mounted between the upright timbers of the memorial shelter. Memorial rights to display a plaque are granted for 25 years (renewable). The memorial can be ordered on the Interment Form or a separate application form is available here .
Plants and trees	To conserve the Listed parkland landscape and the natural habitat, no trees are planted on graves. Groups of oak trees were planted to commemorate the Queen's Diamond Jubilee and these are now maturing well. To protect wildlife and bereaved families from unwanted change, nothing should be planted and no seeds should be scattered without our consent.

Further Information

Baby & infant funerals	Wales has a scheme in place, whereby no fees should be charged for the burial of a child or person under the age of 18 (including stillborn and foetal remains), which we support. https://leedam.com/advice/childrens-funerals/
Direct burials	A direct/simple natural burial can be arranged for families who do not wish to attend the burial. Full grave location details will be provided on the burial certificate.
Burial ground rules	Outlined in full here - www.leedam.com/rules-and-regulations
Maintenance	The burial ground is maintained as agricultural grassland. It will be mown three times a year. Sheep may be brought in to graze the land and when they do, be careful where you tread.
Long term security	The land has planning consent for use as a natural burial ground combined with agriculture. This gives it a high level of protection. There is no real chance of the land being redeveloped at any time in the future - read more here: www.leedam.com/future-security

Cardiff & The Vale

Natural Burial Meadow

Tel: 01446 364128